

# Application Case Story

## APPLICATION:

Residential Garbage Disposal

## MATERIAL:

Meldin 1380

## PART DEFINITION:

Chopper Bearing

## TECHNICAL DATA:

TYPICAL DIMENSIONS:

.50" I.D. x 1.00" O.D.

SPEED: 600 feet/minute

COUNTERFACE: Hard Chrome-Plated Stainless Steel

LUBRICATION: Water

WORKING TEMPERATURE:

Approximately 150°F

## FEATURES / BENEFITS:

- Material has good wear properties
- Material is forgiving with foreign particles present in application

This bearing is molded directly onto the stainless steel chopper screen. The ability of SGPPPL to do this eliminates an assembly operation for the appliance manufacturer, thereby reducing their costs.



MELDIN 1380 BEARING

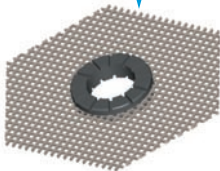

CHOPPER SCREEN

Saint-Gobain  
Performance Plastics Corporation  
386 Metacom Avenue  
Bristol, Rhode Island 02809-5126

Tel: 401.253.2000  
Fax: 401.253.8211

ACS-401-1M-1101SGCS

